



|  |   |              |                            |
|--|---|--------------|----------------------------|
|  | <b>Product information</b><br><b>TD100-17/2</b> | Manufacturer | CNP                        |
|  |   | Address      | Yuhang District, Hangzhou, |
|  |   | Contact      | 86-571-88637351            |
|  |   | Date         | 2022/03/09                 |
| Project Name   |   | Client Name  | DPA                        |
| Station Number   |   | Client Addr. |                            |
|  |   | Contacts     | Alireza                    |
|  |   | Contact      |                            |

|             |            |
|-------------|------------|
| Product No. | 1100041802 |
|-------------|------------|

|   |  |
|---|--|
| Product picture(Note:the picture may not be the same as the                       | Series description   |
|  | <p>Product introduction</p> <p>Single stage in-line centrifugal pumps,inlet and outlet are horizontal with top side pulled out structure and can be repaired without removing the pipelines.</p> <p>Performance and advantages</p> <p>Compact structure<br/>Maintenance convenience<br/>Low noise<br/>Both cast iron and stainless steel impeller are available</p> <p>Application range</p> |

### technology

|                    |                 |
|--------------------|-----------------|
| Pump rotator speed | 2900            |
| Pump version       | Extension shaft |

### Material

|             |       |
|-------------|-------|
| Impeller    | HT200 |
| Pump body   | HT200 |
| Rubber code | NBR   |

### Installation

|                            |      |
|----------------------------|------|
| Connection Code            | F    |
| Maximum Operation Pressure | PN12 |

### Medium

|                    |         |
|--------------------|---------|
| Medium Temperature | -15~110 |
|--------------------|---------|

### Structure dimension

|                           |  |
|---------------------------|--|
| Inlet & outlet size types | DN                                       |
| Inlet & Outlet Bore       | 100                                      |
| Rotation Direction        | Clockwise rotation viewed from motor end |

### Motor

|                         |             |
|-------------------------|-------------|
| Number of Motor Phase   | Three Phase |
| Protection Class        | IP55        |
| Insulation Class        | F           |
| Motor Power             | 5.5         |
| Power Frequency         | 50Hz        |
| Rated Voltage (V)       | 380V        |
| Energy Efficiency Level | IE3         |

### Seal

|                 |             |
|-----------------|-------------|
| Mechanical Seal | TD-28/B2SE4 |
|-----------------|-------------|

### Others

|             |     |
|-------------|-----|
| Weight (kg) | 119 |
|-------------|-----|

|  |   |              |                            |
|--|---|--------------|----------------------------|
|  | <b>Performance Curve</b><br><b>TD100-17/2</b> | Manufacturer | CNP                        |
|  |   | Address      | Yuhang District, Hangzhou, |
| Project Name   |   | Contact      | 86-571-88637351            |
|  |   | Date         | 2022/03/09                 |
| Station Number   |   | Client Name  | DPA                        |
|  |   | Client Addr. |                            |
|  |   | Contacts     | Alireza                    |
|  |   | Contact      |                            |

Medium Name Clear Water , Temperature 20°C, Density 1000kg/m³, Viscosity 1mm²/s, (ISO99062012 Grande 3B)

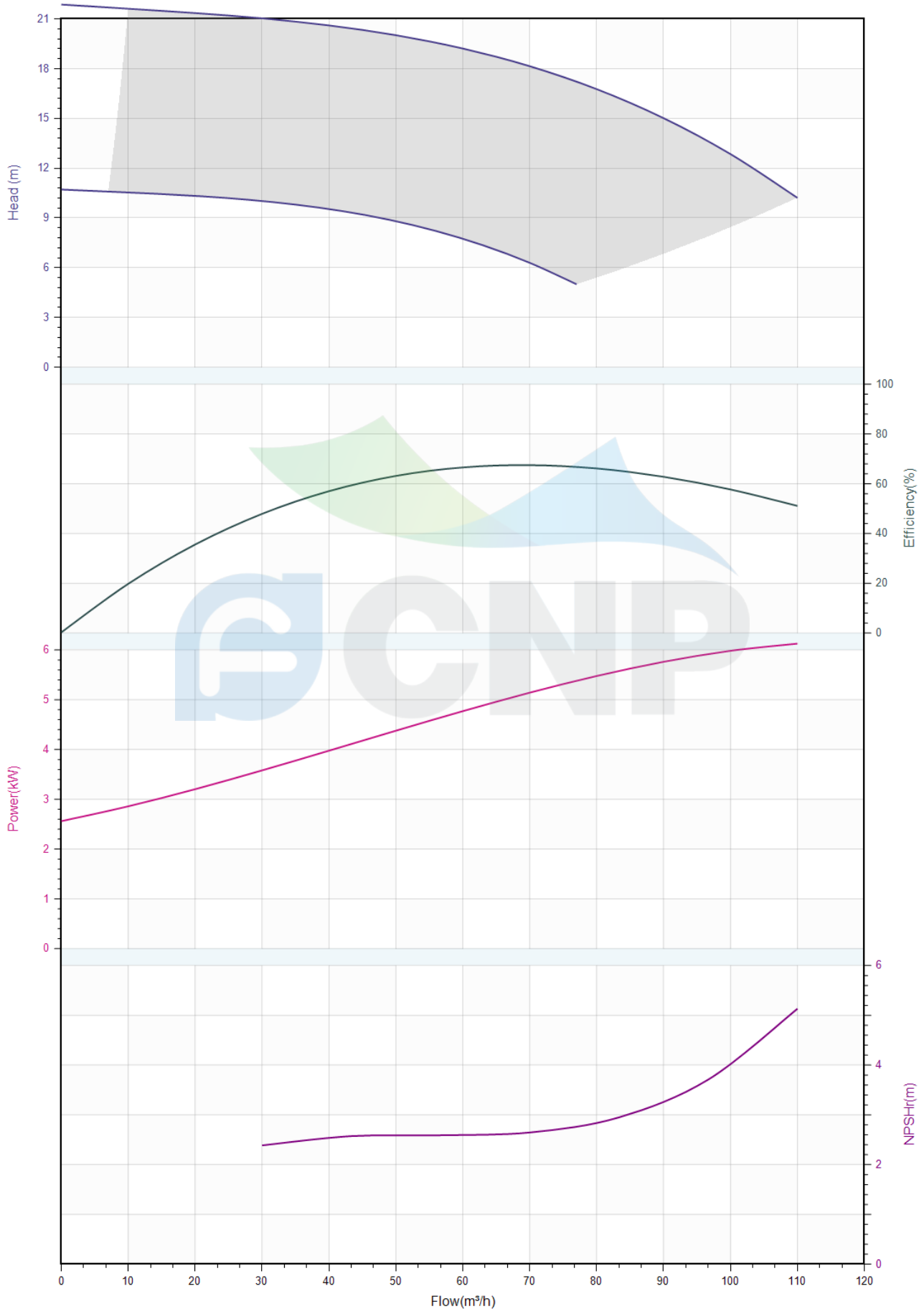

|  |   |              |                            |
|--|---|--------------|----------------------------|
|  | <b>Pump technical parameters</b><br><b>TD100-17/2</b> | Manufacturer | CNP                        |
|  |   | Address      | Yuhang District, Hangzhou, |
| Project Name   |   | Contact      | 86-571-88637351            |
|  |   | Date         | 2022/03/09                 |
| Station Number   |   | Client Name  | DPA                        |
|  |   | Client Addr. |                            |
|  |   | Contacts     | Alireza                    |
|  |   | Contact      |                            |

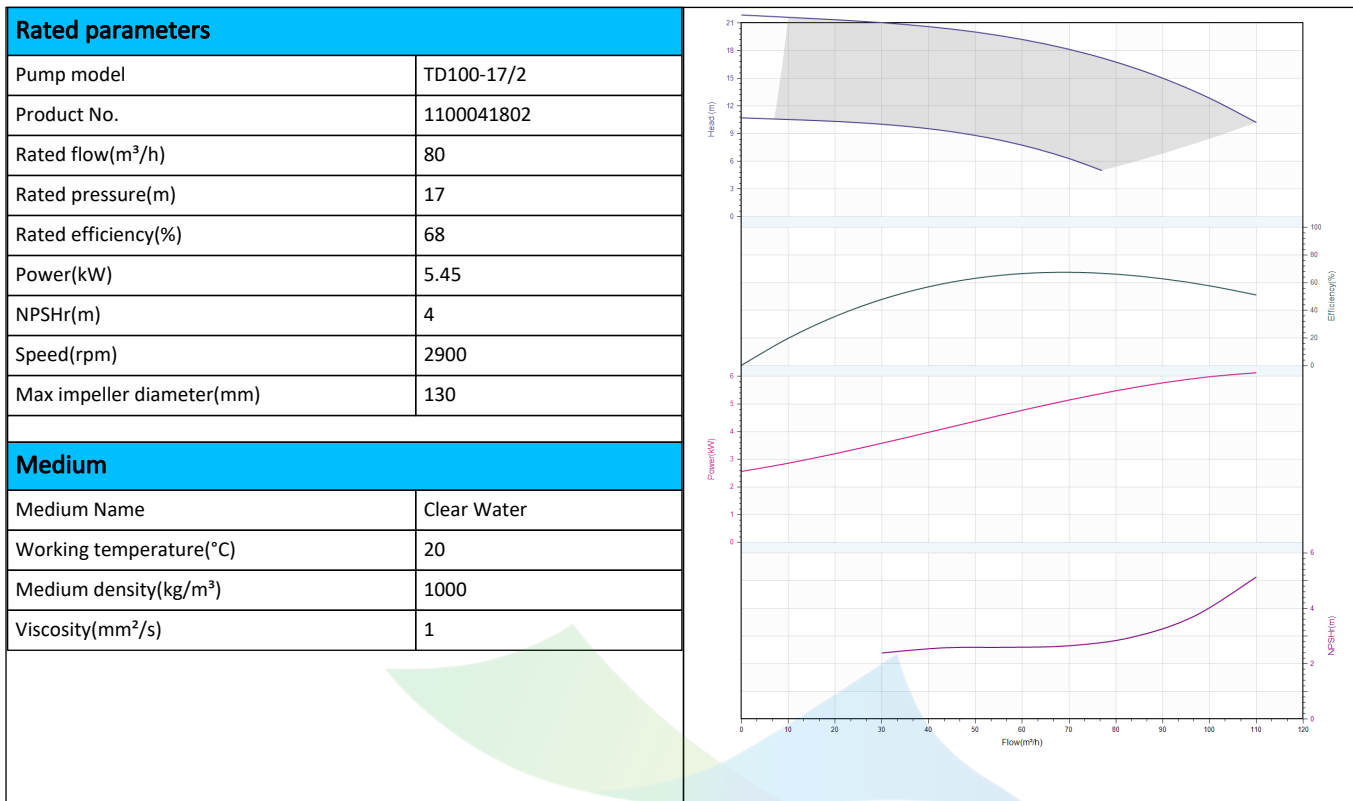

|  |   |              |                            |
|--|---|--------------|----------------------------|
|  | <b>Structure picture</b><br><b>TD100-17/2</b> | Manufacturer | CNP                        |
|  |   | Address      | Yuhang District, Hangzhou, |
| Project Name   |   | Contact      | 86-571-88637351            |
|  |   | Date         | 2022/03/09                 |
| Station Number   |   | Client Name  | DPA                        |
|  |   | Client Addr. |                            |
|  |   | Contacts     | Alireza                    |
|  |   | Contact      |                            |

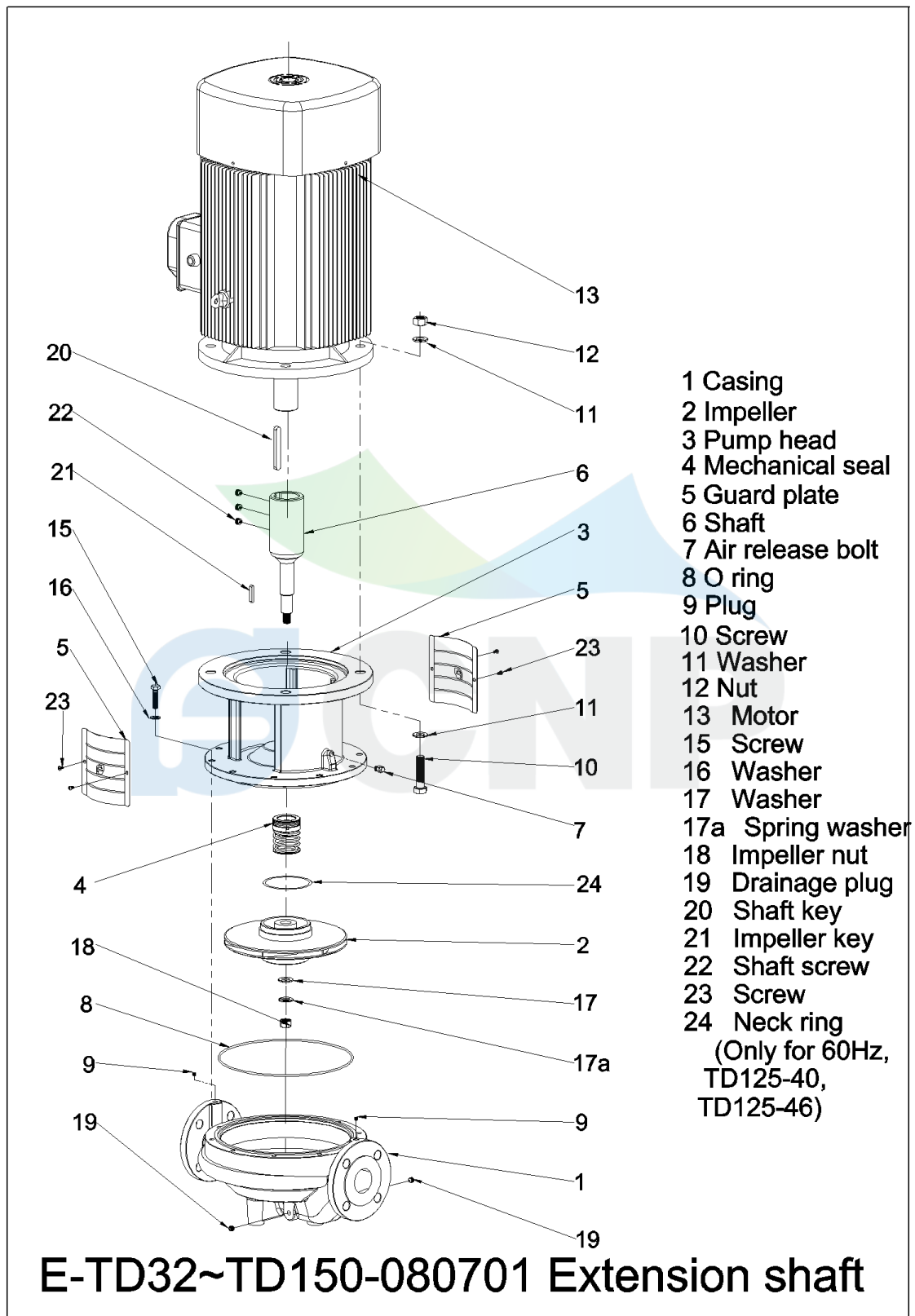

|  |  |              |                            |
|--|--|--------------|----------------------------|
|  | <b>Size picture</b><br><b>TD100-17/2</b> | Manufacturer | CNP                        |
|  |  | Address      | Yuhang District, Hangzhou, |
| Project Name   |  | Contact      | 86-571-88637351            |
|  |  | Date         | 2022/03/09                 |
| Station Number   |  | Client Name  | DPA                        |
|  |  | Client Addr. |                            |
|  |  | Contacts     | Alireza                    |
|  |  | Contact      |                            |

