	<b>Product information</b> <b>TD50-50/2</b>	Manufacturer	CNP
		Address	Yuhang District, Hangzhou,
		Contact	86-571-88637351
		Date	2022/03/09
Project Name		Client Name	DPA
Station Number		Client Addr.	
		Contacts	Alireza
		Contact	

Product No.	1100042163
-------------	------------

Product picture(Note:the picture may not be the same as the	Series description
	<p><b>Product introduction</b></p> <p>Single stage in-line centrifugal pumps,inlet and outlet are horizontal with top side pulled out structure and can be repaired without removing the pipelines.</p> <p><b>Performance and advantages</b></p> <p>Compact structure Maintenance convenience Low noise Both cast iron and stainless steel impeller are available</p> <p><b>Application range</b></p>

### technology

Pump rotator speed	2900
Pump version	Extension shaft

### Material

Impeller	HT200
Pump body	HT200
Rubber code	NBR

### Installation

Connection Code	F
Maximum Operation Pressure	PN12

### Medium

Medium Temperature	-15~110
--------------------	---------

### Structure dimension

Inlet & outlet size types	DN
Inlet & Outlet Bore	50
Rotation Direction	Clockwise rotation viewed from motor end

### Motor

Number of Motor Phase	Three Phase
Protection Class	IP55
Insulation Class	F
Motor Power	11
Power Frequency	50Hz
Rated Voltage (V)	380V
Energy Efficiency Level	IE3

### Seal

Mechanical Seal	TD-28/B2SE4
-----------------	-------------

### Others

Weight (kg)	181
-------------	-----

	<b>Performance Curve</b> <b>TD50-50/2</b>	Manufacturer	CNP
		Address	Yuhang District, Hangzhou,
Project Name		Contact	86-571-88637351
		Date	2022/03/09
Station Number		Client Name	DPA
		Client Addr.	
		Contacts	Alireza
		Contact	

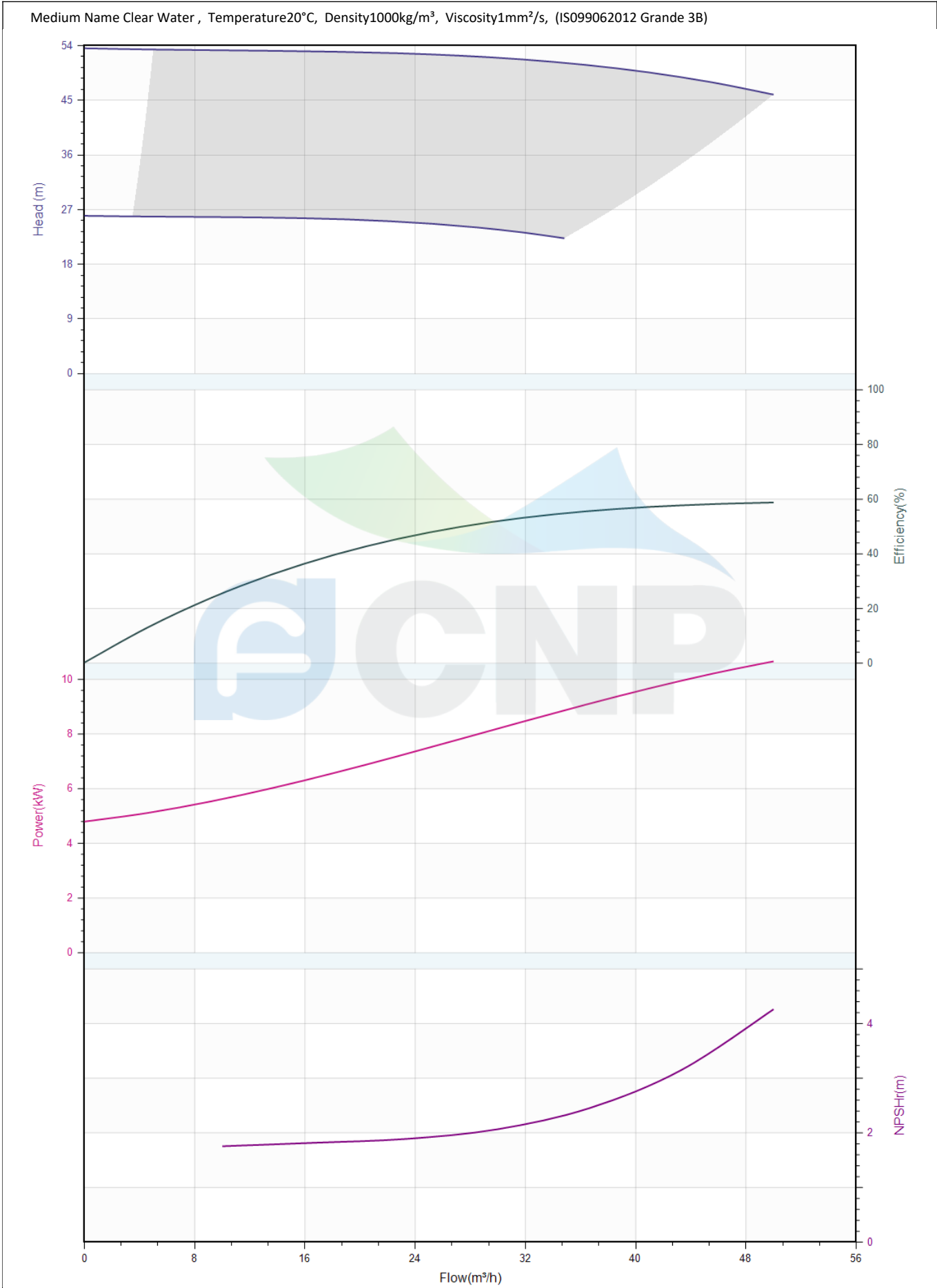

	<b>Pump technical parameters</b> <b>TD50-50/2</b>	Manufacturer	CNP
		Address	Yuhang District, Hangzhou,
		Contact	86-571-88637351
		Date	2022/03/09
		Client Name	DPA
Project Name		Client Addr.	
Station Number		Contacts	Alireza
		Contact	

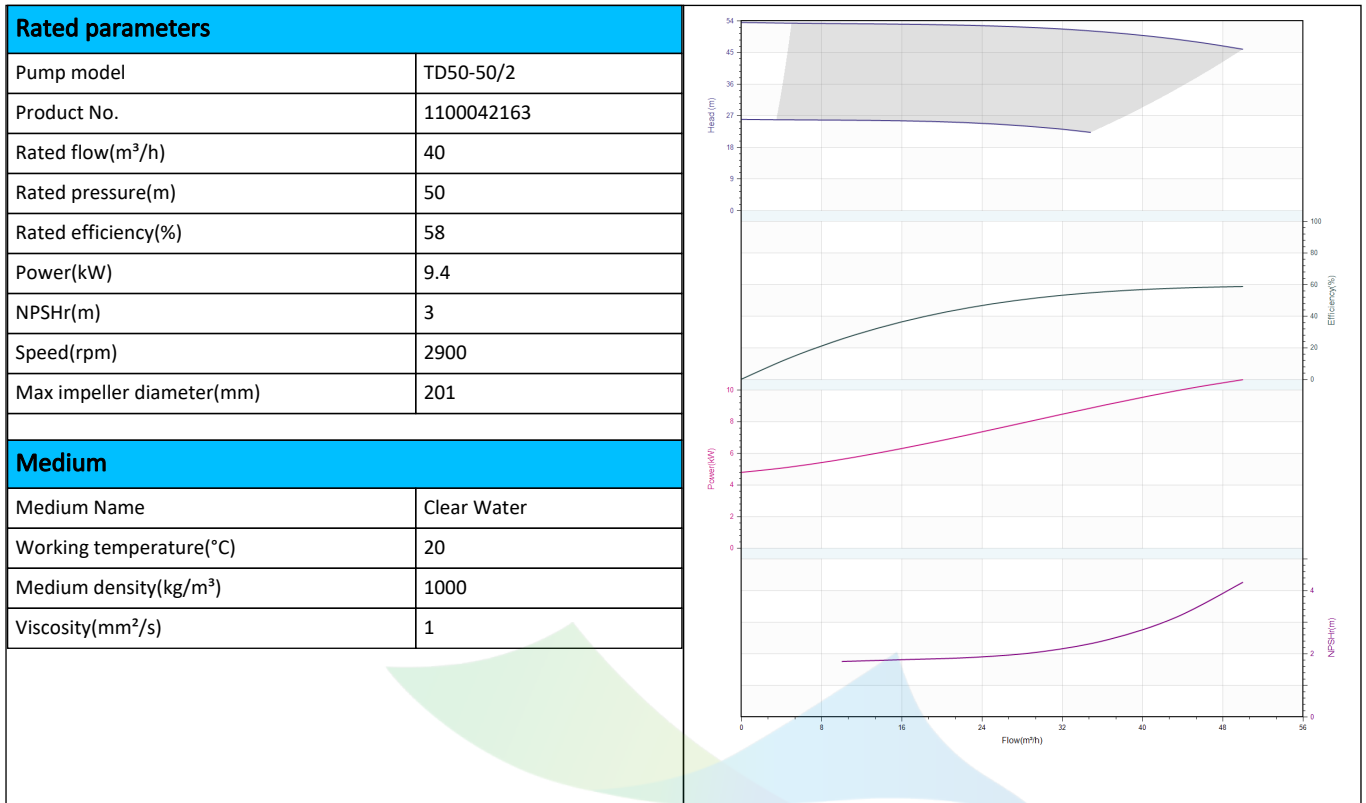

	<b>Structure picture</b> <b>TD50-50/2</b>	Manufacturer	CNP
		Address	Yuhang District, Hangzhou,
		Contact	86-571-88637351
		Date	2022/03/09
Project Name		Client Name	DPA
Station Number		Client Addr.	
		Contacts	Alireza
		Contact	

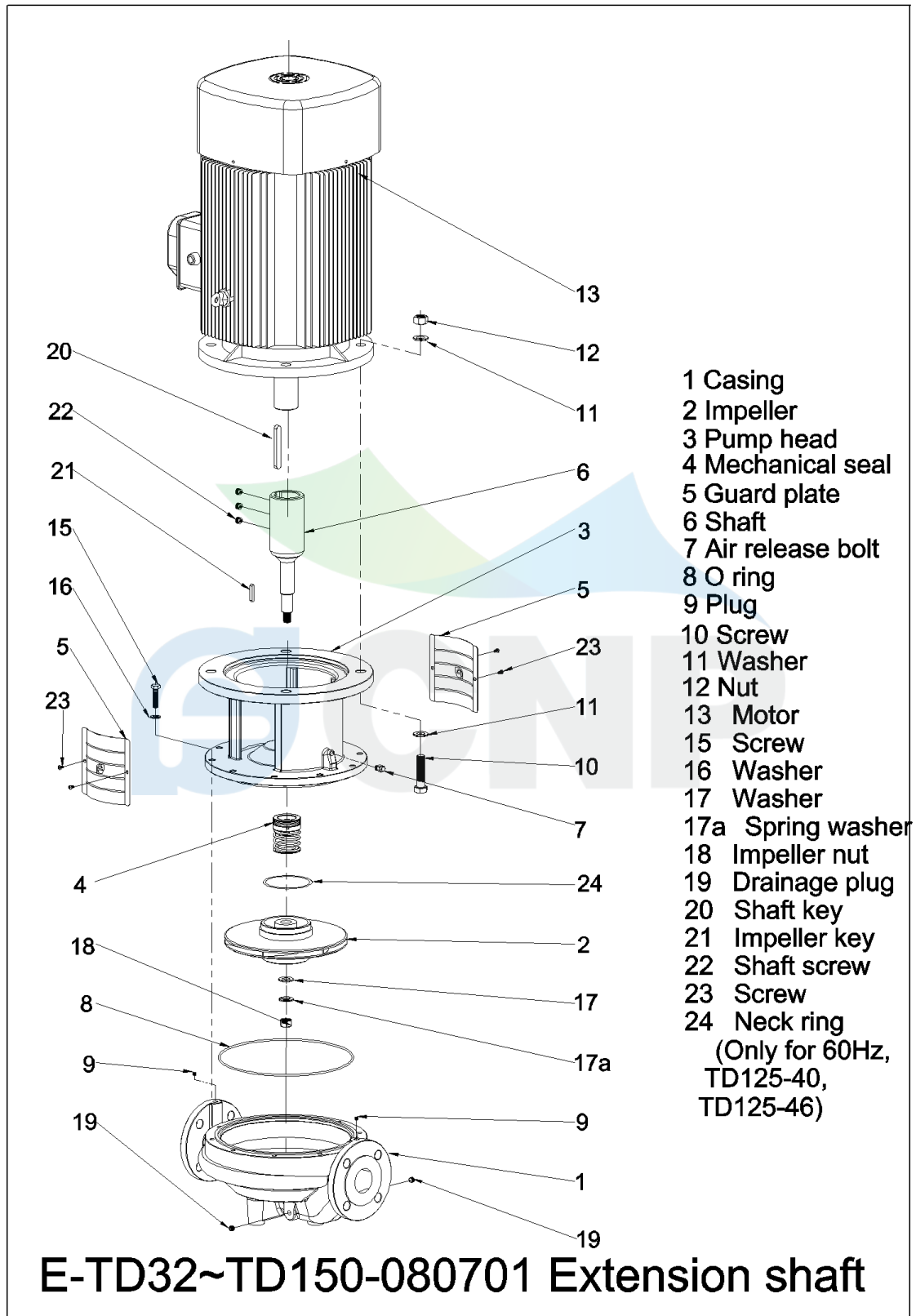

	<b>Size picture</b> <b>TD50-50/2</b>	Manufacturer	CNP
		Address	Yuhang District, Hangzhou,
Project Name		Contact	86-571-88637351
		Date	2022/03/09
Station Number		Client Name	DPA
		Client Addr.	
		Contacts	Alireza
		Contact	

